



Durand Worm Gears

Thickener Drives



www.cmdgears.com





Presentation

CMD has designed a new range of drives for clarifiers and thickeners based on **Durand ZA-profile** worm gears that are particularly suitable for low speed operations.

On one hand, the lower the speed, the higher the torque transmissible by the **ZA gear** and, on the other hand, the «enveloping» shape of the wheel teeth maximizes bending strength to withstand occasional rake blockages inside the tank. CMD also provides continuous torque measurement and associated control packs to enable real-time monitoring and process optimization.

1

ENGINEERING



2

MANUFACTURING

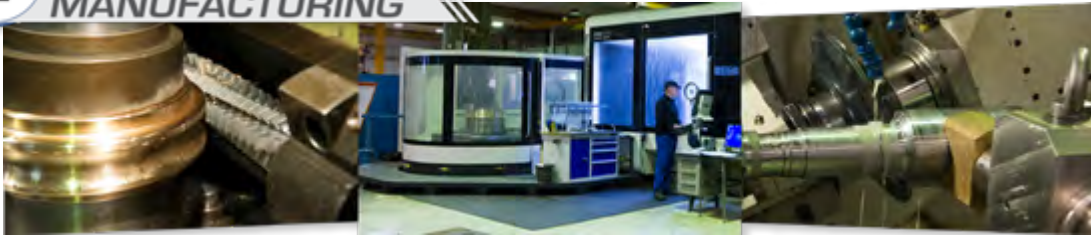

3

ASSEMBLY



4

SERVICE



Advantages



Worm & Wheel **DURAND ZA®**

- > **Maximise** teeth stiffness to resist peak torques
- > **Optimize** meshing surface to increase life duration

- > Corrosion proof
- > Overload proof
- > Long duration

Description

8 sizes for nominal torque up to 350 000 Nm

3 Executions :

- > **Plain** : No sensor
- > **Local** : Manual or automated drive
- All necessary sensors
- > **Complete** : Local execution + full automation
- According customer's grafcet

2 Arrangements :

- > Rotation (R)
- > Rotation & Lifting (RL)



Electronic display

Torque limiter control & security switch



Security torque limiter

Rake position indicator



Rake position lights



Stainless steel torque sensor

Worm & Wheel
DURAND ZA®
Inside



Corrosion proof bellow

Removable connecting flange



For any QUERY or request for QUOTATION :
contact@cmdgears.com

Drives for CHEMICAL INDUSTRIES



Flotation & High - Torque Agitators



Autoclaves



Granulators & Dryers



Ball mills Vertical mills

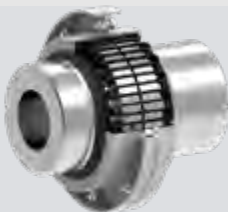

Flexacier[™] Flexident[™]



French design & manufacture



HEAD OFFICE
& CAMBRAI PLANT
539, Avenue du Cateau
59400 CAMBRAI
FRANCE

SALES OFFICE
36, Avenue de l'Europe
Immeuble de l'Etendard BP43
78142 VELIZY-VILLACOUBLAY
FRANCE
+33 (0)1 34 63 12 24

FOURCHAMBAULT PLANT
33, rue du 4 septembre
58600 FOURCHAMBAULT
FRANCE

